



OWNER'S MANUAL & WARRANTY



VIPER FOOD SHIELDS

Thank you for choosing products from BSI. We appreciate your business and are available to assist you with all of your needs. This manual has been designed to help you better understand your product and its proper usage. If you have questions that go beyond this detailed manual, please contact our Customer Service Department at 800.662.9595.

TABLE OF CONTENTS

Important Owner Information	2	Viper Bracket Assembly & Parts.....	6
Safety Precautions	3	Bracket Operation.....	7-8
Receipt and Inspection of Equipment	3	Cleaning Instructions.....	9
		End Panels.....	9
Viper Food Shields		Mounting Options.....	10
Models	3	Installation Instructions.....	11
Basic Components and Layout	4		
Viper Bracket	5	Warranty	12

This manual is an important part of your equipment. Your Owner's Manual should be stored in a safe location as it will be useful for the life of your product. It contains important safety information concerning the maintenance, operation, and servicing of these products.

Failure to properly follow this manual may result in serious injury. Do not operate this equipment unless you have read and understood the manual contents.

IMPORTANT OWNER INFORMATION

Record your guards' model number(s) and light/warmer unit serial number(s) (if applicable) to use as a reference when contacting your local representative or BSI headquarters.

Model No.:	
Serial No.:	
Model No.:	
Serial No.:	
Date of Purchase:	
Other:	

BSI Corporate Headquarters Information:

Business Hours: 8:00 AM to 5 PM MST

Telephone: 800.662.9595

Fax: 303.331.8444

Web Address: www.bsidesigns.com

SAFETY PRECAUTIONS



The Viper food guard must be installed in accordance with applicable installation code by a person familiar with the product's construction, operation, and potential hazards involved.

RECEIPT AND INSPECTION OF EQUIPMENT

Care should be taken during unloading and uncrating to avoid equipment damage.

1. Visually inspect the package, skid, or container exterior. Any damage should be noted and reported to the delivering carrier immediately.
2. Open and inspect contents for broken glass and verify that all items were received.
3. In the event that damage is discovered, notify the carrier and request freight damage forms.
4. Request an inspection by the shipping company of the damaged equipment. This should be done within 10 days of equipment receipt.
5. Retain all crating materials until an inspection has been made or waived.
6. All packages contain a product owner's manual and warranty document, along with installation drawings for your installer.

All Viper models are certified by NSF.



VIPER MODELS

Viper food guards are manufactured in many different configurations. While the components are similar, your model's glass and posts may not be. The models shown below should be maintained in the same manner based on the instructions within this manual.



EV100



EV100A



EV101A



EV101A-2

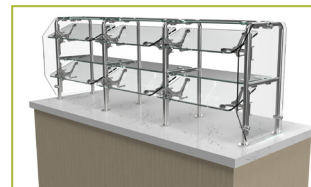

EV101A-3



EV112A

BASIC COMPONENTS AND LAYOUT

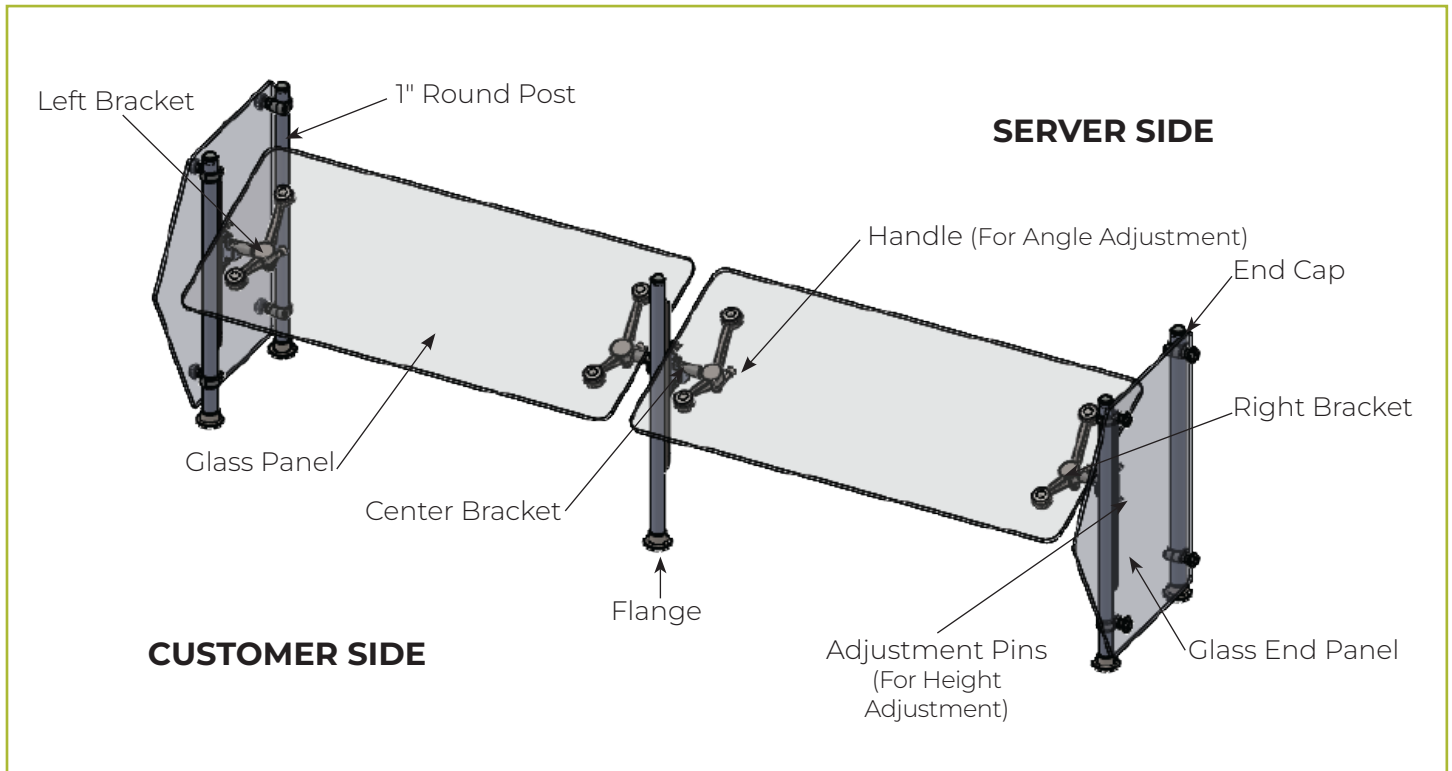

VIPER BRACKETS & PARTS

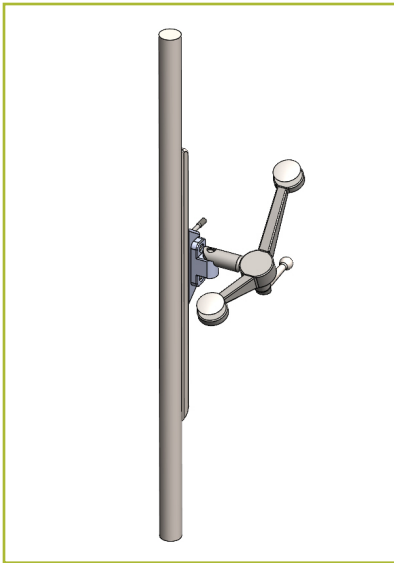

Left Viper Bracket

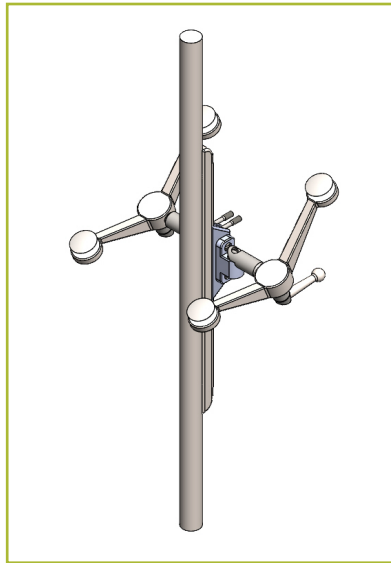

Center Viper Bracket

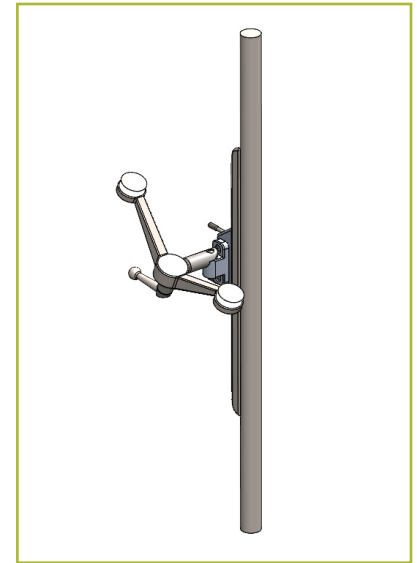

Right Viper Bracket

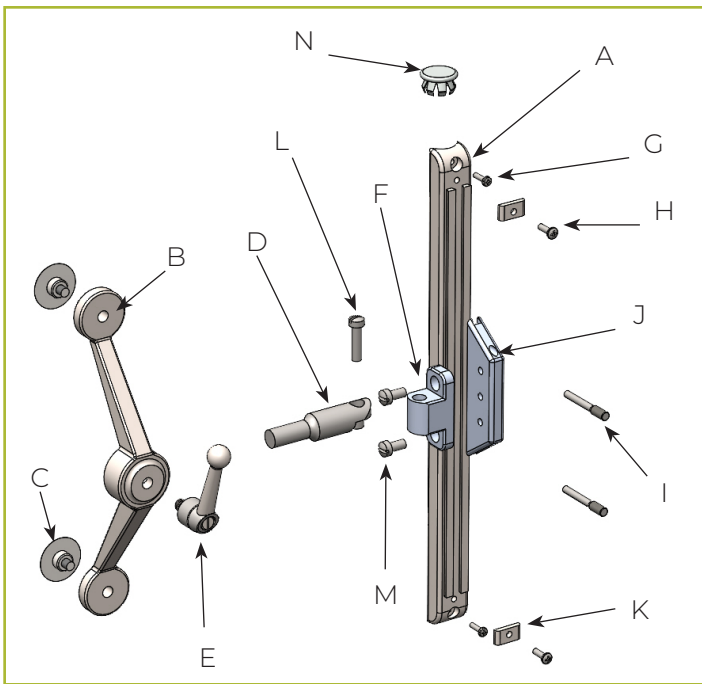

Exploded View

Location	Part #	Description
A	17525	Track Block
B	17515	Viper Spider Bracket
C	17517	Viper Glass Cap With Screw
D	17510	Viper Arm
E	17514	Viper Ratchet Handle
F	17508	Viper Block
G	17358	Screw 6-20 x .5" Self Tapper
H	17315	Screw 8-32 x .5" Pan Head
I	17513	Thumb Screws
J	17500	AMA Slider
K	17533	Stopper Block
L	17310	Screw 1/4-20 x 1" Slot
M	17314	Screw 1/4-20 x .5" Slot
N	17562	End Cap

How to Order Replacement Parts

Phone: 800.662.9595
 Email: sales@bsidesigns.com

Be sure to designate part finishes when ordering.

VIPER BRACKET ASSEMBLY & PARTS

Exploded view showing the fixed end and the fixed angle bracket.

Location	Part #	Description
O	17536	Viper Fixed Angle Bracket
P	17534	Viper Fixed End Bracket
Q	17538	Viper Fixed Center Bracket

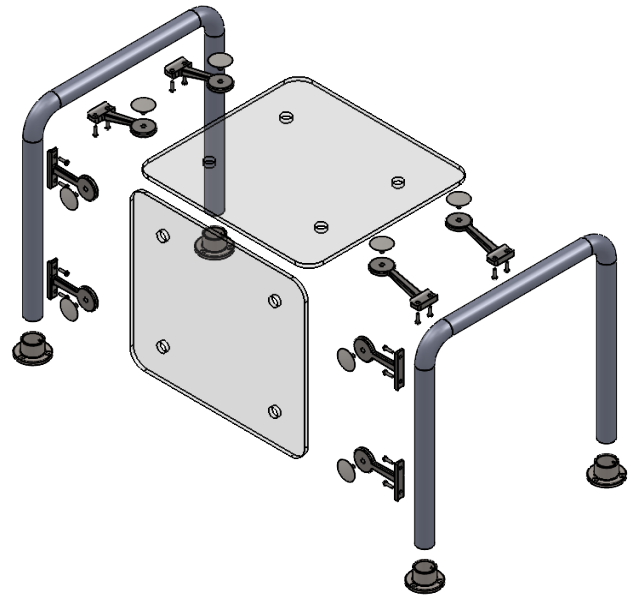
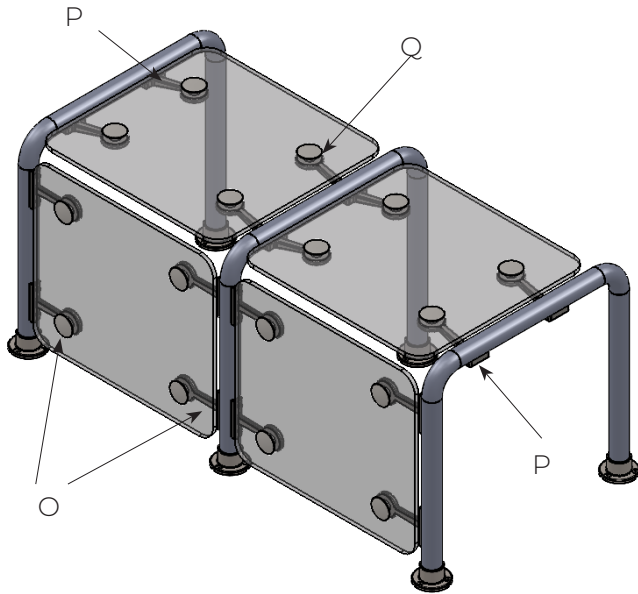

Viper bracket featuring top glass, fixed end bracket, and center bracket.

How to Order Replacement Parts

Phone: 800.662.9595
 Email: sales@bsidesigns.com

Be sure to designate part finishes when ordering.

VIPER ANGLE ADJUSTMENT

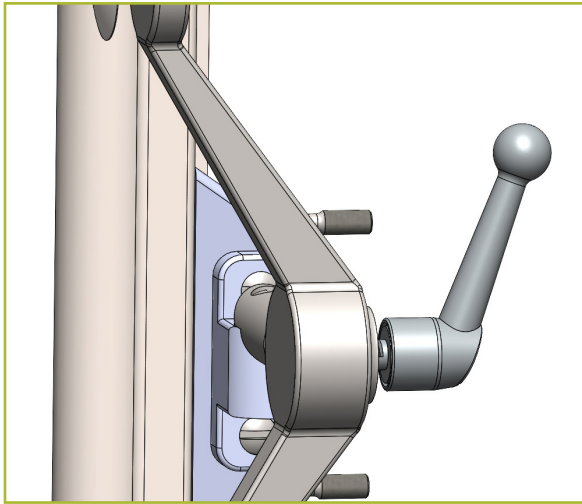

SPRING LOADED VIPER HANDLE:

Spring loaded Viper handle can be used like a ratchet when space does not allow handle to make a full turn.

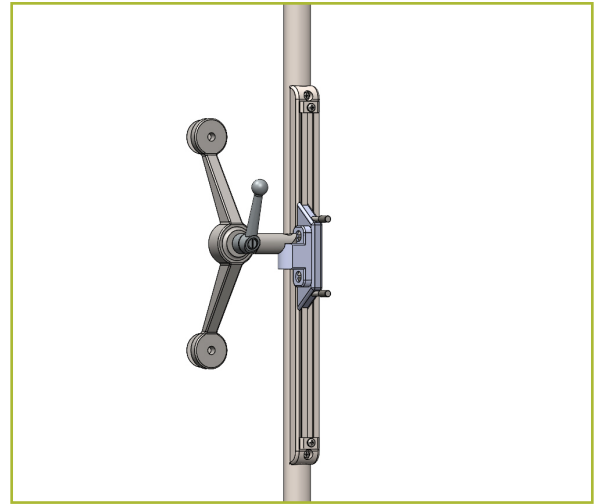

Loosen handle 1/4 - 1/2 of a rotation. Tighten handle after desired angle is achieved.

1. When adjusting or performing maintenance, BSI recommends two people to hold and move the guard. Using only one person may cause damage to the brackets.
2. Hold the glass in place while loosening both handles about 1/4 - 1/2 turn. Do not remove screw or loosen more than one full turn. Do not force the glass to rotate. If both handles are loose, the glass will move freely.
3. Once both sides are loosened, gently rotate the glass to the desired position. Tighten both handles before releasing the glass. Do not over tighten. Over tightening will cause the screw to strip the bracket.
4. Repeat steps 2-4 to adjust the glass angle.

VIPER HEIGHT ADJUSTMENT

STEP 1:
Loosen thumb screws.

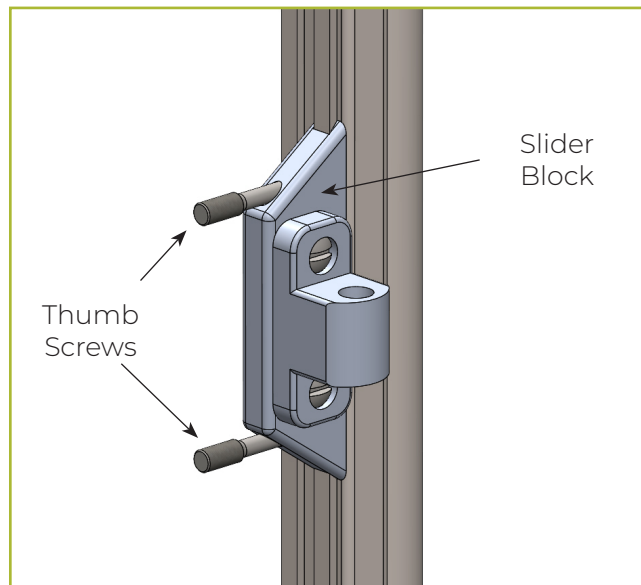

STEP 2:
Move the slider block to the desired location.

1. Locate the slider block at the top of the track.
2. While holding glass in place, slightly loosen the thumb screws (two per bracket). It is not necessary to completely unscrew thumb screws to the point of removal.
3. Move slider block up or down to reach desired location. For longer units (50" or longer), BSI recommends that two people adjust the glass height.
4. Once at desired height, tighten each thumb screw. Do not over tighten as it may cause damage to the threads and/or bracket.



GLASS LIMITATIONS

Glass Thickness	Permissible Load (Pounds Per Square Feet)				
	12" Span	24" Span	36" Span	48" Span	60" Span
1/4"	73.5 lbs.	15.9 lbs.	5.3 lbs.	1.5 lbs.	N/A
3/8"	196.7 lbs.	45.5 lbs.	17.5 lbs.	7.7 lbs.	3.2 lbs.
1/2"	345.4 lbs.	81.4 lbs.	32.6 lbs.	15.4 lbs.	7.5 lbs.

CLEANING INSTRUCTIONS

- Wipe the surface with a clean, damp cloth to remove fingerprints, dust, etc.
- Spray with a light coating of glass cleaner to remove grease and dirt. Use a non-ammonia cleaner.
- Do not use brass polish on your food guards as it will degrade the finish.
- Do not scrub the surface with abrasives like steel wool, pot scrubbers, abrasive powders, or similar products as they will remove the protective coating.
- If unit is fitted with a warmer, do not clean the glass or housing when warmer is hot. **Cleaning warmer when hot can cause staining or damage to warmer finish.**

VIPER END PANELS

To meet NSF guidelines, end panels are included on all BSI quotations unless otherwise specified.

Part #	Part Name
16617	End Panel Collar Assembly

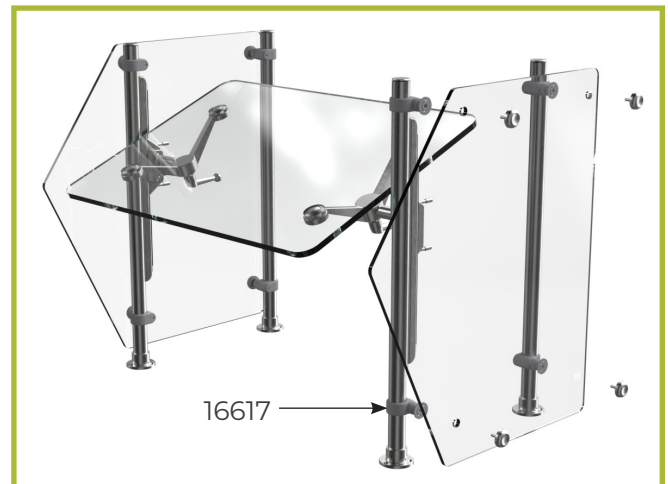

NSF End Panel Requirement Exemption

NSF/ANSI Standard 2 - 2018

5.36.1.6.2 A food shield intended to be installed a maximum of 3 inches (76 mm) from a building wall perpendicular to the food shield is exempt from the requirements of 5.36.1.6.1 provided that the height of the building wall is not lower than the overall height of the food shield. The manufacturer's specification sheet, brochure, installation instructions, and/or shop drawings shall include these building wall and proximity requirements.

Mounting Options for 1" Round Post

MILLWORK COUNTERTOP

Above Counter - Millwork Mount

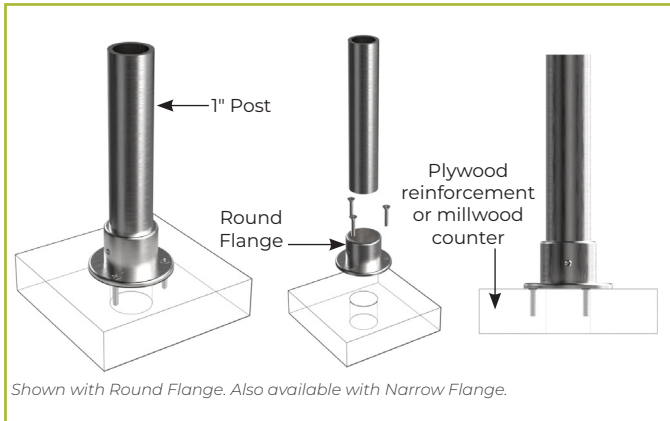

STAINLESS STEEL COUNTERTOP

Above Counter - Triton Mount

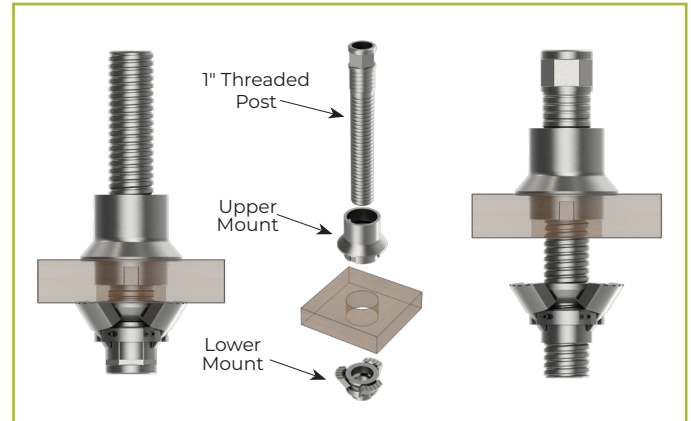

Below Counter - Compression Flange Mount

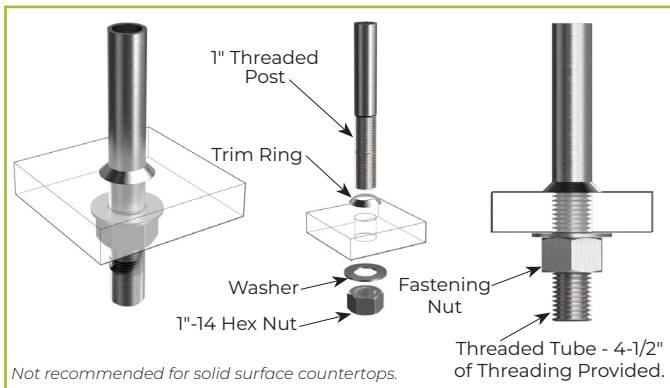

Below Counter - Upright Flange Mount w/ Plate

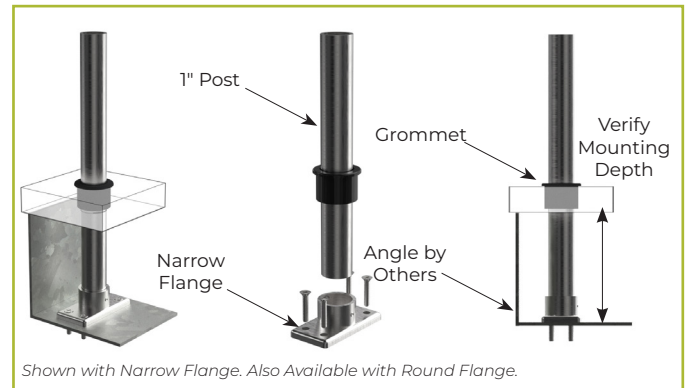

Below Counter - Inverted Flange with Plate

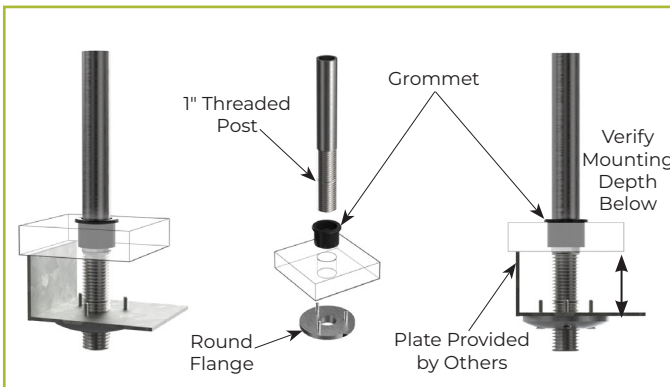

Below Counter - Inverted Flange with Plate

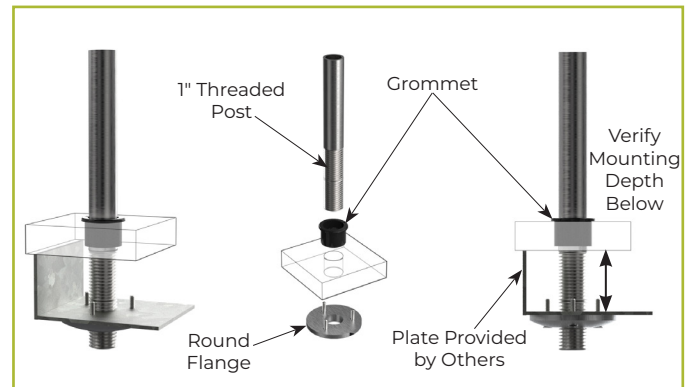

INSTALLATION INSTRUCTIONS

Step 1: Review approval drawings then locate and place end post on the counter in proper location.



Step 2: Mark holes with a pencil. Set post aside and drill pilot holes where marked.

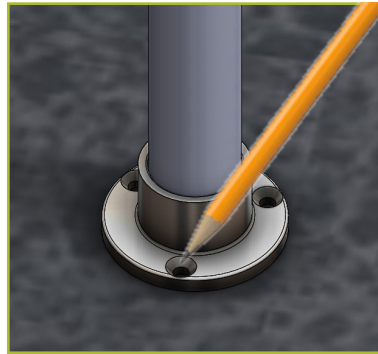

Step 3: Align pilot holes with flange holes and insert screws. Tighten screws firmly in place.

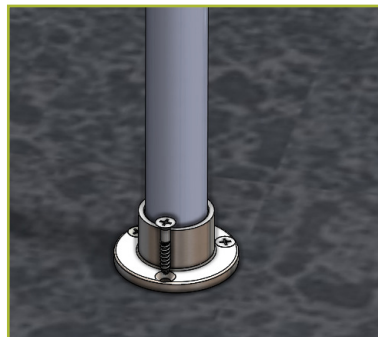

NOTE: Mounting style may vary. Please refer to flange options (page 10) for more details.

Step 4: Measure the center line from flange to flange to locate your second post position.

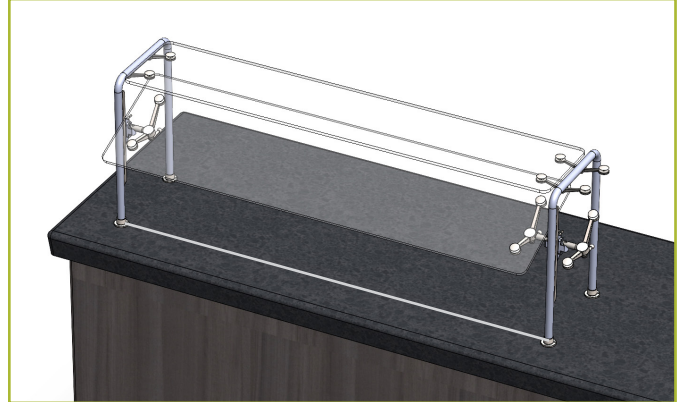

NOTE: Customer can use the glass as a guide to determine post location.

Step 5: Repeat steps 2-5 to install remaining posts.

Step 6: Slide glass into glass clips.



Step 7: Tighten glass using Allen wrench provided. Using your thumb and index finger, tighten as far as you can with the short end of the wrench between your fingers.

BSI E-SERIES WARRANTY

BSI, LLC warrants its products to be free of material and workmanship defects under normal use from the date of original purchase and for the applicable warranty periods set forth below. BSI, LLC's warranty extends only to original purchasers acquiring new products purchased in the United States directly from BSI, LLC, its authorized dealers, or other companies specifically authorized by BSI, LLC to act as resellers of its products.

E-SERIES FOOD GUARDS

BSI, LLC warrants all E-Series food guards against material and workmanship defects for a period of one year from invoice date. This excludes post-installation glass chipping or breakage that can be explained as "standard wear and tear."

HELIOS® LIGHTS & WARMERS

BSI, LLC warrants the Helios housing, warming element, and light ballast against material and workmanship defects for a period of one year from invoice date. The LED bulb itself is not covered under warranty.

THERE ARE NO WARRANTIES EXCEPT AS STATED ABOVE, WHETHER EXPRESSED OR IMPLIED, INCLUDING, BUT NOT LIMITED TO, ANY WARRANTY OF MERCHANTABILITY OR FITNESS FOR A PARTICULAR PURPOSE. Warranties do not apply to products that have been altered in any way or to products subjected to misuse, abuse, neglect, accident, or damage in transit. Warranty is void if products are used, held, or stored in an unsupervised environment. BSI, LLC's liability shall be limited to product repair or replacement, or refund of purchase price issued at the discretion of BSI, LLC. BSI, LLC will not be liable, under any circumstances, for incidental or consequential damages (including, without limitation, to lost profits) arising in connection with the sale, use, inability to use, repair, or replacement of BSI, LLC's products. The liability of BSI, LLC arising from any cause shall not exceed the price paid for the products.

Any breach claim of the foregoing warranties shall be deemed waived unless submitted to BSI, LLC in writing within 30 days of alleged defect discovery date or by reasonable inspection should have been discovered. Merchandise must be returned to the BSI, LLC factory, freight prepaid, and will not be accepted unless a prior Return Merchandise Authorization (RMA) has been issued by BSI, LLC. A copy of the original invoice must accompany the returned merchandise to verify the original purchase date and warranty entitlement. Any cause of action for breach of the foregoing warranties shall be deemed waived unless brought within one year of claim submission.